

PROJECT CONTROL COORDINATES

Pnt No.	Northing	Easting	Pnt Elev	Description
1	713192.025	2268537.999	774.84'	Iron Pin Set
2	713239.449	2268790.451	776.40'	Iron Pin Set
3	713415.092	2268335.384	745.91'	Mag Nail Set
4	714378.577	2268876.917	619.67'	Iron Pin Set
5	714869.183	2268899.850	615.57'	Iron Pin Set
23	713781.528	2268623.477	707.54'	Drill Hole Set
24	713367.216	2268299.400	-	Iron Pin Found

SURVEYING PARAMETERS

USE THE FOLLOWING VERTICAL POSITIONING AND HORIZONTAL POSITIONING PARAMETERS FOR ALL SURVEYING:

VERTICAL POSITIONING

ORTHOMETRIC HEIGHT DATUM: NAVD 88
 GEOID: 2012A US
 ASSUMED AVERAGE PROJECT HEIGHT = 700.00'

HORIZONTAL POSITIONING

REFERENCE FRAME: NAD 83 (2011) 2011.0 EPOCH
 ELLIPSOID: GRS80
 MAP PROJECTION: LAMBERT CONFORMAL CONIC
 COORDINATE SYSTEM: OHIO STATE PLANE (NORTH ZONE)
 COMBINED SCALE FACTOR: 1.0000000

UNITS ARE IN U.S. SURVEY FEET.

EXISTING CONDITIONS REFERENCES:

- LAKE COUNTY GIS INFORMATION 2017.
- CT CONSULTANTS INC. FIELD SURVEY INFORMATION JANUARY 2017.
- WAITE HILL ROAD RIGHT-OF-WAY WAS OBTAINED FROM THE RIVER-BOW SUBDIVISION AS SHOWN BY PLAT RECORDED IN VOLUME G, PAGE 78 OF LAKE COUNTY RECORDS, AND A STORM SEWER REPLACEMENT PLAN FOR WAITE HILL ROAD DATED 1929.

EXISTING CONDITIONS NOTES:

- EXISTING STRUCTURES, GRADES, PIPING, ETC. ARE SHOWN IN APPROXIMATE LOCATION ON THE PLANS. INFORMATION SHOWN IS NOT GUARANTEED TO BE CORRECT AND COMPLETE. THE CONTRACTOR IS RESPONSIBLE FOR FIELD VERIFYING ALL DATA SHOWN ON THESE PLANS PRIOR TO CONSTRUCTION.
- ALL KNOWN ABOVE AND BELOW GROUND UTILITIES HAVE BEEN NOTED ON THE DRAWINGS. THESE UTILITIES BEEN APPROXIMATELY LOCATED BY FIELD SURVEYS OR OBTAINED VIA UTILITY COMPANY RECORD DRAWINGS. NO GUARANTEE IS MADE RELATIVE TO THE COMPLETENESS OR ACCURACY. THE CONTRACTOR ACCEPTS FULL RESPONSIBILITY FOR ANY UTILITIES DAMAGED DURING THE PROJECT CONSTRUCTION WHETHER SHOWN ON THE PLANS OR NOT. ANY SUCH LAND RESTRICTIONS, IF ENCOUNTERED, WILL BE THE CONTRACTOR'S RESPONSIBILITY TO RESOLVE.
- THIS PLAN HAS BEEN PREPARED WITHOUT THE BENEFIT OF A TITLE REPORT AND MAY BE SUBJECT TO EASEMENTS AND OTHER RESTRICTIONS, EITHER RECORDED OR UNRECORDED. THE SURVEYOR HAS MADE NO INVESTIGATION OR INDEPENDENT SEARCH FOR EASEMENTS, RECORD ENCUMBRANCES, RESTRICTIVE COVENANTS OR ANY OTHER FACTS THAT AN ACCURATE AND CURRENT TITLE SEARCH MAY DISCLOSE.
- ATTENTION IS DIRECTED TO THE FACT THAT THESE PLANS MAY HAVE BEEN ALTERED IN SIZE BY REPRODUCTION. THIS MUST BE CONSIDERED WHEN OBTAINING SCALED DATA.
- THE PROJECT CONTROL COORDINATE SYSTEM IS BASED UPON THE FOLLOWING:
 - HORIZONTAL DATUM - PROJECT CONTROL COORDINATES FOR THIS PROJECT HAVE BEEN ESTABLISHED BY GPS/RTK OBSERVATIONS UTILIZING THE OHIO CO-ORDINATE SYSTEM OF 1983 (ZONE 3401-OHIO NORTH). OHIO STATE PLANE GRID COORDINATE VALUES ARE EXPRESSED IN UNITS OF U.S. SURVEY FEET "ON THE GRID" AND HAVE NOT BEEN ADJUSTED FOR USE "ON THE GROUND."
 - VERTICAL DATUM - NORTH AMERICAN VERTICAL DATUM OF 1988 (NAVD88).
- THE SURVEY AND STREET ALIGNMENTS SHOWN HEREON WERE OBSERVED IN THE FIELD FOR CONSTRUCTION PURPOSES ONLY AND MAY NOT BE SUITABLE FOR PROPERTY LINE SURVEYS OR OTHER PURPOSES.
- THE BENCHMARK ELEVATIONS SHOWN IN THE PROJECT CONTROL TABLE ARE AT THE TOP OF THE RED CAP OF THE IRON PIN SET.
- IRON PINS SET ARE 5/8" IRON PINS SET WITH A RED CAP INSCRIBED WITH "CT REF"

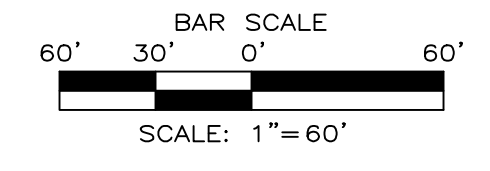
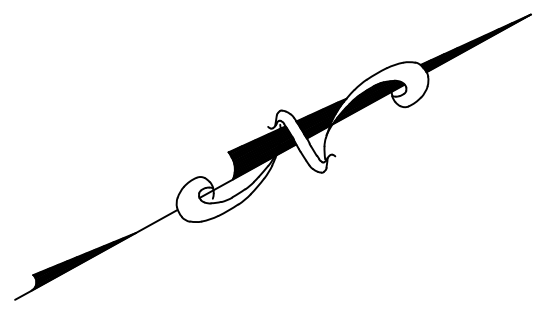

LEGEND

	SURVEY CONTROL / REFERENCE POINT SET
	EXISTING SURVEY MONUMENTATION FOUND
	CALCULATED LOCATION OF CENTERLINE OF STREET.

PROPOSED STORM SEWER ALIGNMENT

Station	Northing	Easting
50+00.00	714451.136	2268939.290
50+16.40	714435.160	2268942.984
50+36.96	714414.639	2268944.234
50+58.65	714393.733	2268938.432
50+73.91	714381.677	2268929.083
51+18.39	714343.872	2268905.637
51+76.24	714286.428	2268898.824
52+02.39	714261.505	2268890.904

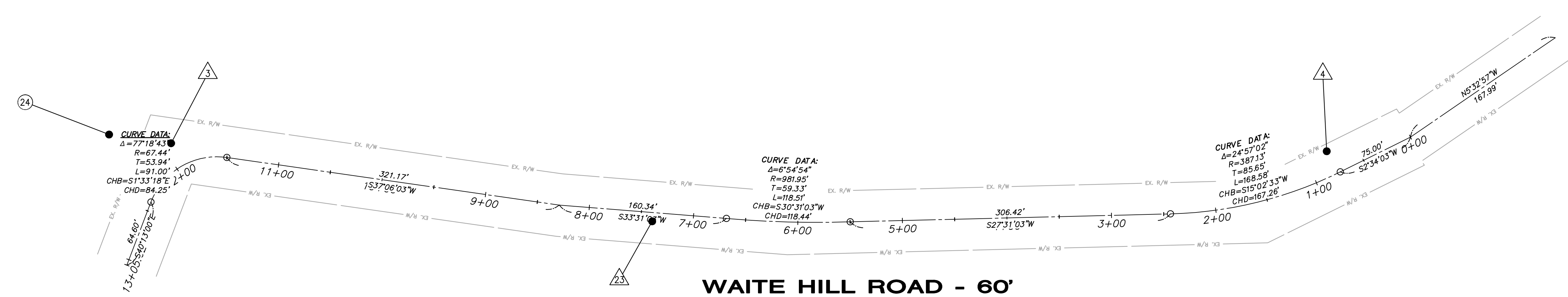

WAITE HILL ROAD - 60'

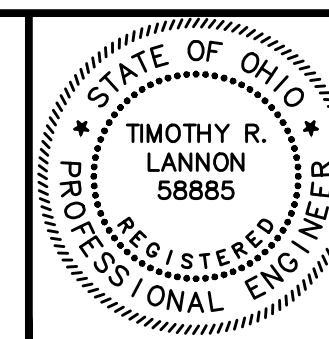

NO	REVISION	DATE

WAITE HILL ROAD IMPROVEMENTS
 VILLAGE OF WAITE HILL, OHIO

SCALE: AS SHOWN
DATE: JULY 2017
DESIGNED BY: JNS
DRAWN BY: JNS
CHECKED BY: TRL

SURVEY CONTROL

PROJECT NO: 16001801	
DRAWING NAME SC-1	
SHEET 2	OF 11